

2500 kg Load Capacity

ST-52 Steel Chassis

Broad Service Network

Use Easy & Effortless

JDAIMA
Move The Future

Durability

ST-52. UNIQUE FRAME

Industry's strongest steel (high tensile sheet steel with an high durability of 52 kg per millimeters used automotive and tower cranes)



Supporting Plates

Extra supporting plates on under of the chassis load carrying part or connections.

Casting Pump

Excellent casting pump with pump with foot controlled lowering valve. Galvanized casting pump is manufactured well known the possible product capacity so that it can work on hard working conditions for many years.

Powder painting and oven drying are increasing capable of adapting to heavy and hard-working conditions.

Special Design and Compact Design

Special design and compact structure combine with perfect welding and production to increase durability.

High Quality



CE-Certification with SGS

CE-Certification with
SGS approval valid throughout.

Certification Europe

UKCA-Certification, ISO 9001, ISO 4001,
ISO 45001 Certification.

Total Quality Management

Total Quality Management at all stages
raw materials to packaging of the
final product.

FIRST

MANUAL TRUCK PALLET IN TÜRKIYE

Turkey's first manual tuck pallet,
whose quality received a set from
renowned institutions.



SGS

CE

UK
CA

Turkey

Discover
the potential

DESIGN

Different Lengths

Different Wheels

.001

New Generation

When our engineers and designers examined the sector, they created a new product with the information they obtained. Daima truck pallet the newest in the industry.

.002

Custom Design

We have developed colors and designs in line with customer expectations. Galvanized and various different color





Search **01**

As a family with sales experience in the sector, we decided to produce. We researched successful brands in different countries and learned the reasons for their preference. And we got market information.

Experience **02**

We got research on user experience. We discussed this with the team that will design the product. Based on the results, we created our basic brief for the design.

Custom Design **03**

The pallet truck is always unique and the positives in the user experience should be its character. The design and prototype process took about 1 year.

Production **04**

When the prototype of Daima Truck Pallet started to be used, it was confirmed by users that the special design had unmatched strength and durability.

All new with durable special paint. Special color option according to customer preference.

Unique with its high carrying capacity.

OPTIONS

Production Option

Production in different widths
wide range of forks.

Rubber

Wheels more quitter but
make it more difficult to
operate and move.



Polyamide

Polyamide Wheels, which is
durable and easy operate pallet
trucks and little bit noisier.



Polyurethane

Polyurethane Wheels works
quietly but difficult to move.



MAXIMUM WORK WITH MINIMUM EFFORT!

**Convenient and easy
operation with 3D - Handle**

**Optimized front wheel
dimensions**

**Jockey wheel help to easy
enter to pallet**



SERVICE

.003

Spaire Part

We produce continuously, but we keep separate stocks for spare parts.

.004

Guarantee

You get our products with a manufacturer's warranty. We are always with you, not only during the warranty period.

.005

Service Network

As a manufacturer, we follow our product at every point. Therefore, we have a wide service network.





Easy and Quick Change **05**

Easy and quick-change O-ring due to casting pump is open top.

Easy Assemble **06**

Easy assemble to handle and chain control with hole in the handle

Maintenance **07**

Maintenance free casting pump lubrication

Original Parts **08**

It is possible for our products to work and perform in a high quality manner, if the parts that need to be replaced over time are also original. Our service services always offer you original parts.



Broad Service Network

Original Spaire Parts

Technical Details

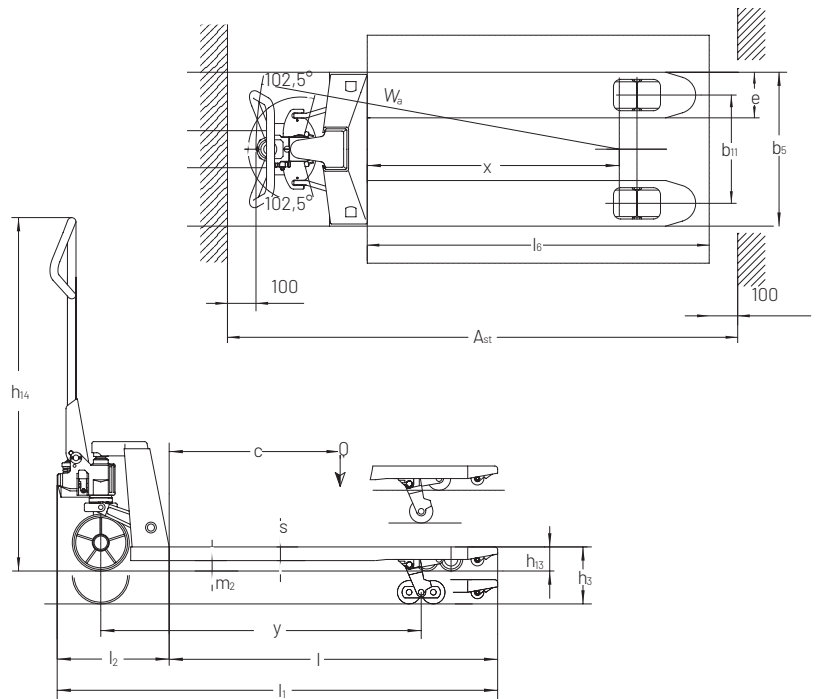

Kennzeichen	1.1	Hersteller			STILL	STILL	STILL	STILL	STILL	
	1.2	Typzeichen des Herstellers			HPS 20	HPS 20 W	HPS 25	HPS 25 W	HPT 10 XM	
	1.4	Bedienung			Gehgerät	Gehgerät	Gehgerät	Gehgerät	Gehgerät	
	1.5	Tragfähigkeit/Last	Q	kg	2000	2000	2500	2500	1000	
	1.6	Lastschwerpunktabstand	c	mm	600	600	600	600	600	
	1.8	Lastabstand	x	mm	972	935	972	935	993	
1.9	Radstand	y	mm	1218	1120	1218	1120	1231		
Gewicht	2.1	Eigengewicht		kg	69	104 ²	70	107 ²	104	
	3.1	Bereifung	vorn/hinten		Nylon/Nylon ¹	Gummi/ Polyurethan Tandem	Nylon/Nylon ¹	Gummi/ Polyurethan Tandem	Nylon/ Polyurethan	
Räder/Fahrwerk	3.2	Reifengröße, vorn		mm	Ø 200 x 50	Ø 180 x 50	Ø 200 x 50	Ø 180 x 50	Ø 200 x 45	
	3.3	Reifengröße, hinten		mm	Ø 80 x 93	Ø 80 x 70	Ø 80 x 93	Ø 80 x 70	Ø 80 x 50	
	3.5	Räder, Anzahl	vorn/hinten			2/2	2/4	2/2	2/4	
	3.6	Spurweite, vorn	b ₁₀	mm	130	130	130	130	155	
	3.7	Spurweite, hinten	b ₁₁	mm	360	445	360	445	447	
	4.4	Hub	h ₃	mm	115	115	115	115	715	
Grundabmessungen	4.9	Höhe Deichselgriff in Fahrstellung	max.	h ₁₄	mm	1230	1215	1230	1215	1285
	4.15	Höhe gesenkt		h ₁₃	mm	85	90	85	90	85
	4.19	Gesamtlänge		l ₁	mm	1545	1580	1545	1580	1545
	4.20	Länge einschließlich Gabelrücken		l ₂	mm	395	430	395	430	395
	4.21	Gesamtbreite		b ₁	mm	520	555	520	555	540
	4.22	Gabelzinkenmaße DIN ISO 2331		s/e/l	mm	48/160/1150	65/180/1150	48/160/1150	65/180/1150	48/160/1150
	4.25	Gabelaußenabstand		b ₅	mm	520	555	520	555	540
	4.32	Bodenfreiheit Mitte Radstand		m ₂	mm	37	25	37	25	21
	4.34.1	Arbeitsgangbreite bei Palette 1000 x 1200 quer		A _{st}	mm	1810	1850	1810	1850	2241
	4.34.2	Arbeitsgangbreite bei Palette 800 x 1200 längs		A _{er}	mm	1790	1830	1790	1830	2091
4.35	Wenderadius		W ₆	mm	1335	1375	1335	1375	1440	

Maximum Work

Maximum work with minimum effort
with optimized Hydraulic.

Foot Controlled

Foot Controlled casting pump for
sensitive lowering.

Excellent Maneuverability

Excellent maneuverability with
210 Degree turning radius.

Operation



JD DAIMA
Move The Future

JD DAIMA
Move The Future

Contact Details

Ready to experience Daima Truck Pallet?
We are waiting for you, ready to produce
solutions for all your questions and problems.

Main Office

Akşemseddin mah. Su Kenarı Cad. No 11/1
Sultanbeyli/İstanbul 34925 Türkiye
Phone/Fax: +90 (216) 509 1515 E-mail: info@daimalift.com

www.daimalift.com